

4

3

2

1

PART NUMBER	DESCRIPTION	QTY
LG-SLIDE-CM-A1	LARGE SLIDE CURD MILL FRAME	1
LG-SLIDE-CM-01	SLIDE MILL- PLASTIC SLIDES	2
LG-SLIDE-CM-CT-A0	SLIDE CUTTER CARRIAGE	1
LG-SLIDE-CM-GRD-01	SLIDE CURDMILL. GUARD 1	1
LG-SLIDE-CM-GRD-02	SLIDE CURD MILL GUARD 2	1
LG-SLIDE-CM-CT-A1	LINKAGE ROTATION ASSEMBLY	1
LG-SLIDE-CM-CT-A2	LINKAGE ASSEMBLY	1
LG-SLIDE-CM-HP-A0	HOPPER ASSEMBLY	1
LG-SLIDE-CM-GRD-A3	LINKAGE GUARD/ COVER	1
LG-SLIDE-CM-GRD-A4	MOTOR GUARD SUB-ASSEMBLY	1
LG-SLIDE-CM-KNOB-A1	GUARD/ HOPPER HOLD-DOWN KNOB	4
LG-SLIDE-CM-MM-A1	MOTOR STANDOFF MOUNT	1
LG-SL-CM-MM-03	MOTOR GASKET	1
LG-SLIDE-CM-19	GASKET HOLD DOWN	1
SL-CM-SHFT-01	SS MOTOR SHAFT	1
3746K31	FLANGED SLEEVE BEARING, 1" SHAFT	2
8558K3	THUMB KNOB, 7 LOB, 3/8"-16	4
92141A033	FLAT WASHER, 1/2"	4
92146A033	LOCK WASHER, 1/2"	4
92240A716	HEX BOLT, 1/2"-13 X 1.375"	4
92141A031	FLAT WASHER 3/8"	6
92146A031	LOCK WASHER, 3/8"	6
92240A624	HEX BOLT, 3/8"-16 X 1" LONG	6
SK1SI75VBIIFBII-N56C-80LP4TW	MOTOR/ GEARBOX, 1 HP, 3PH 230/460 VAC, 25:1 RATIO, 70 RPM	1

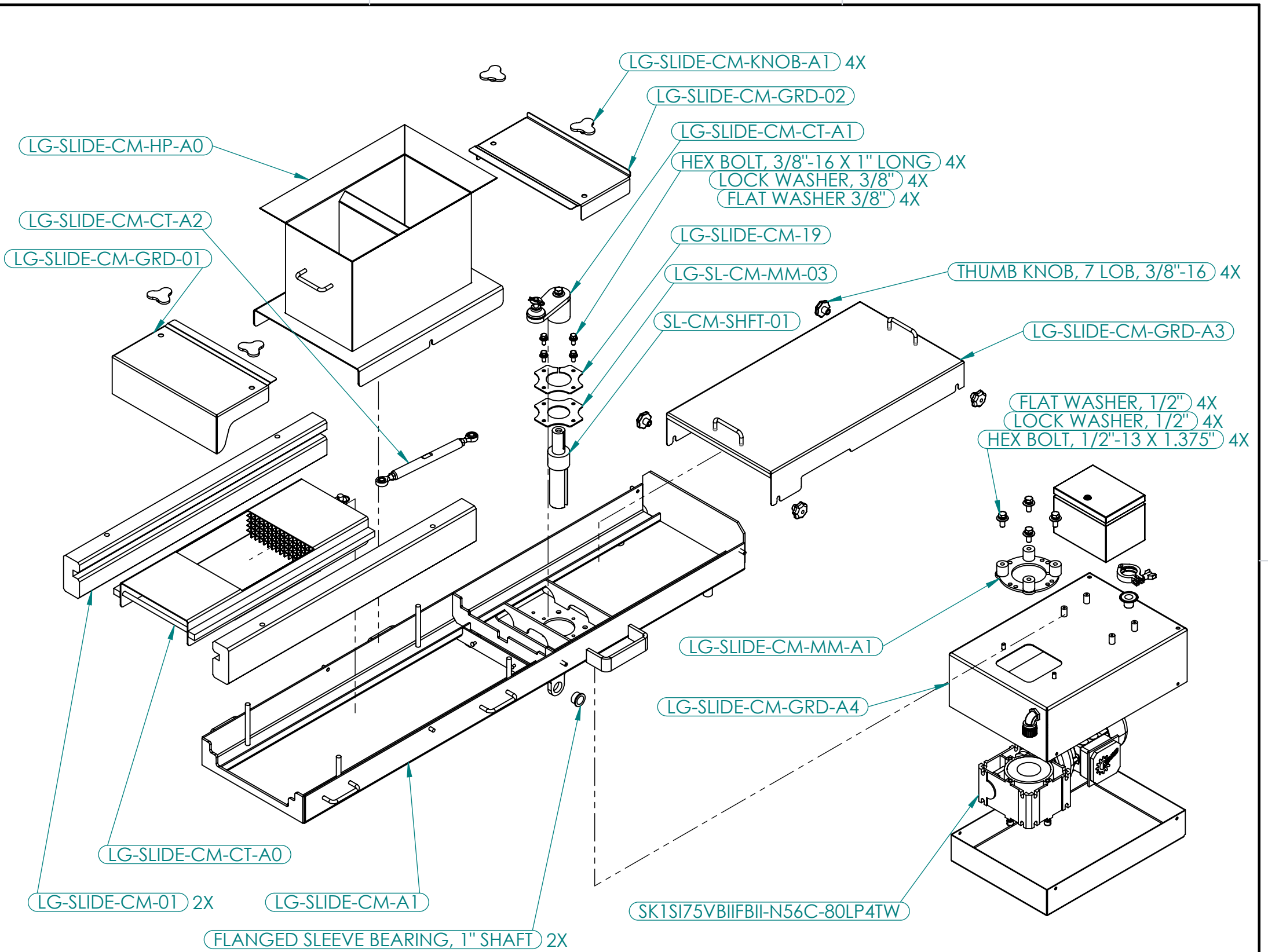

QUANTITY: 1	PUNCH:	DIE:	MATERIAL:	Ullmer's Dairy Equipment & Fabrication			
PROPRIETARY AND CONFIDENTIAL THE INFORMATION CONTAINED IN THIS DRAWING IS THE SOLE PROPERTY OF ULLMERS DAIRY EQUIPMENT. ANY REPRODUCTION IN PART OR AS A WHOLE WITHOUT THE WRITTEN PERMISSION OF ULLMERS DAIRY EQUIPMENT IS PROHIBITED.				UNLESS OTHERWISE SPECIFIED: DIMENSIONS ARE IN INCHES TOLERANCES: FRACTIONAL: ± 1/16 ANGULAR: BEND ± 0.50 TWO PLACE DECIMAL ± .030 THREE PLACE DECIMAL ± .010			
				DRAWN: JTK DATE: 11/4/2024 REVISED: 11/5/2024		TITLE: LARGE SLIDE PART LIST	
REVISIONS		INTERPRET GEOMETRIC TOLERANCING PER: DO NOT SCALE DRAWING		SIZE: B	DWG. NO.: LARGE SLIDE CURD MILL PARTS LIST	REV:	
ZONE	REV.	DESCRIPTION	DATE	APPROVED	SCALE: 1:12	WEIGHT:	SHEET 1 OF 4

4

3

2

1

B

B

A

A

4

3

2

1

LG-SLIDE-CM-A1

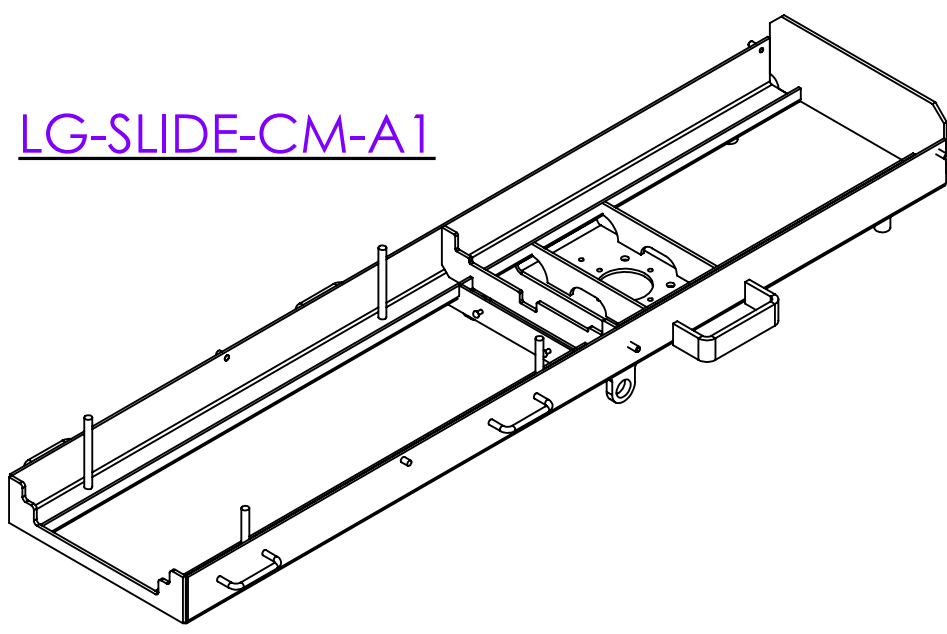

LG-SLIDE-CM-01
QTY 2

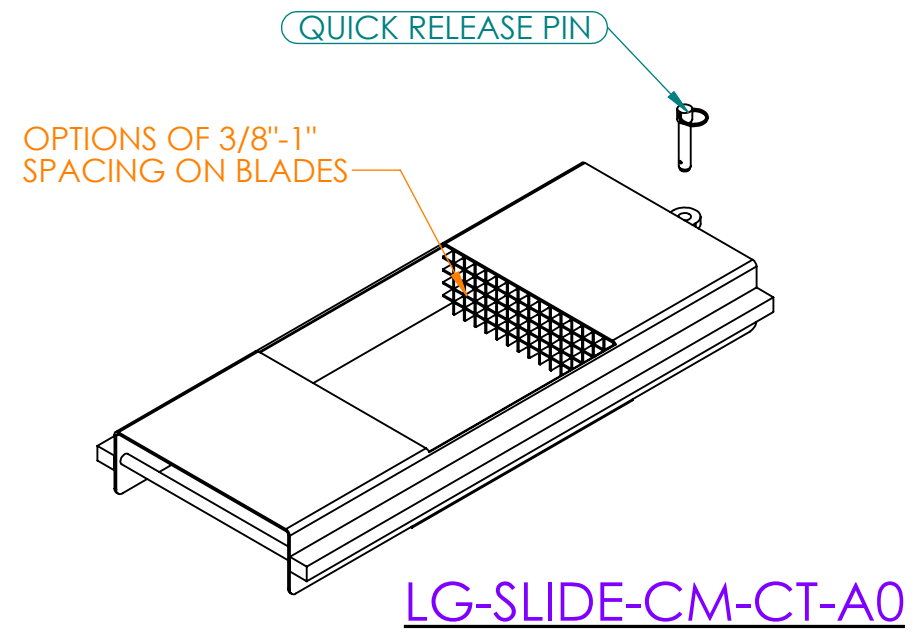
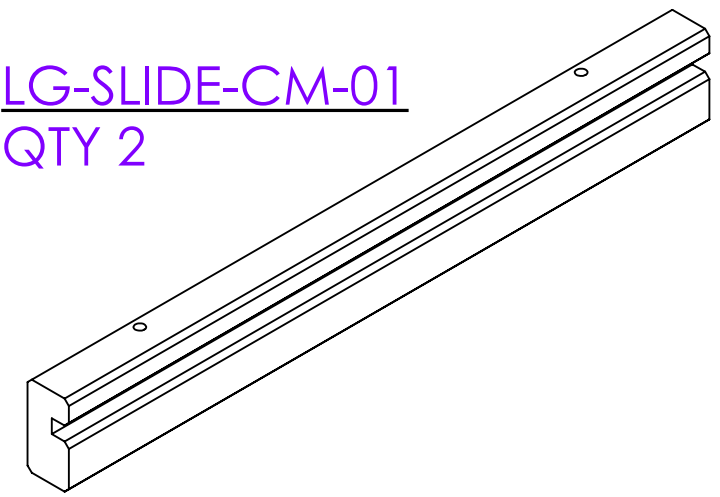

R-CLIP, 1/8" WIRE DIA X 3/8" EYE DIA

FLAT WASHER, 1/2"
LOCK WASHER, 1/2"
HEX BOLT, 1/2"-13 X 1-1/4" LONG

FLAT WASHER, 1/2"

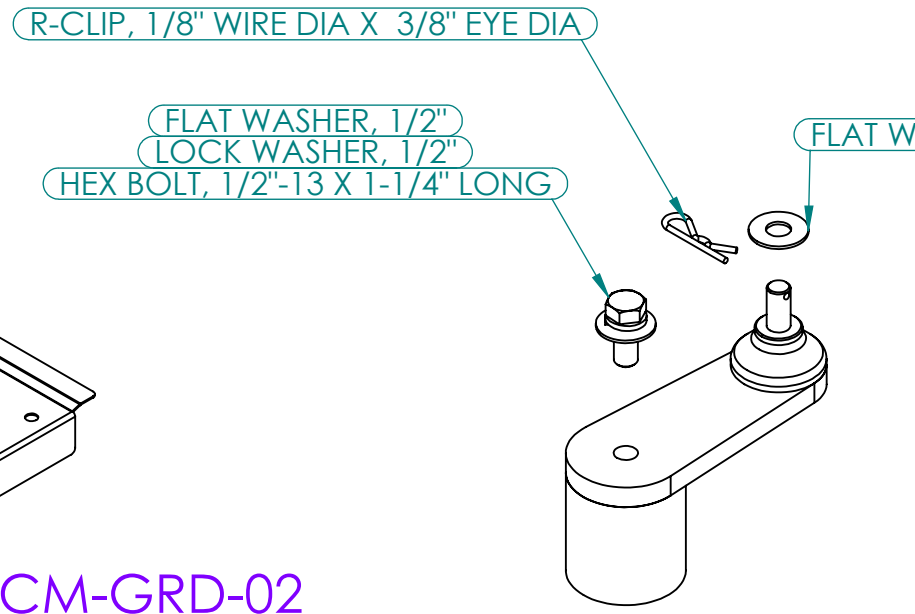
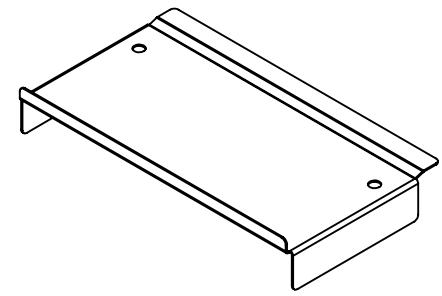
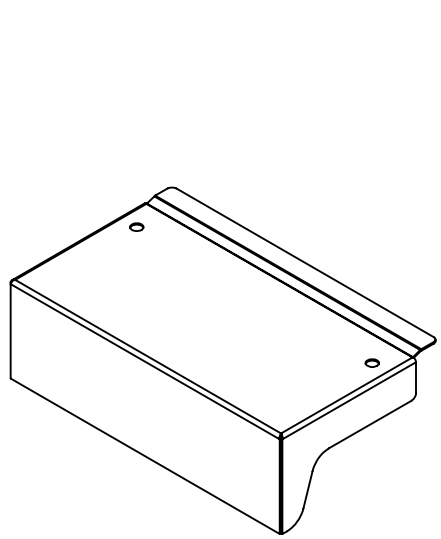

LG-SLIDE-CM-CT-A2

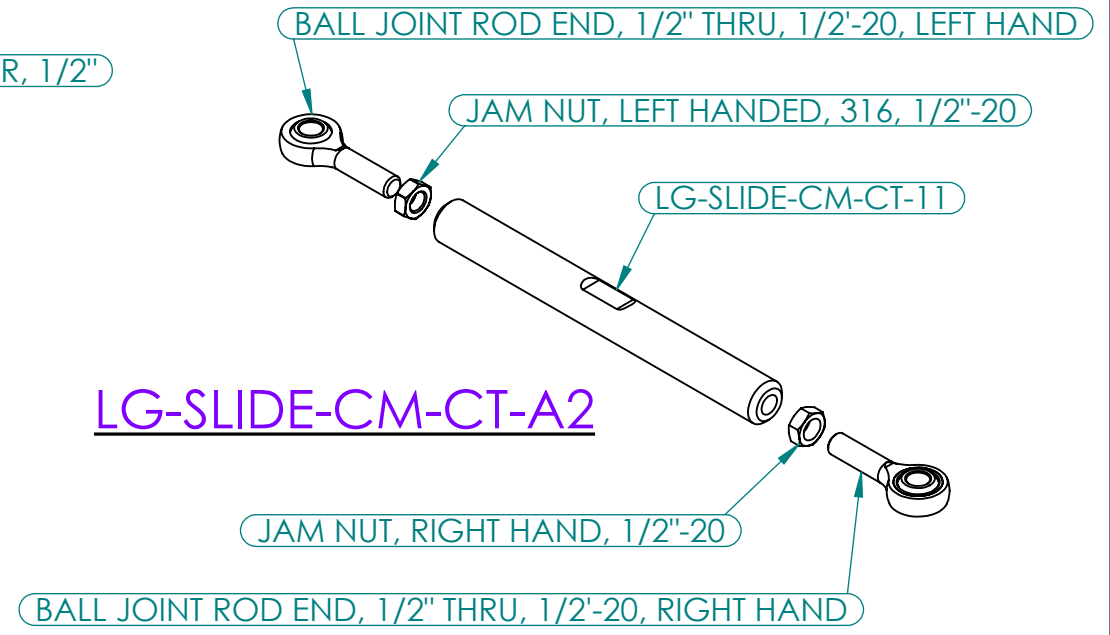

ASSEMBLIES AND PARTS ARE TYPICALLY SOLD TOGETHER,
AS SHOWN
*EXCEPTIONS APPLY

QUANTITY:	PUNCH:	DIE:	MATERIAL:	Ullmer's Dairy Equipment & Fabrication					
PROPRIETARY AND CONFIDENTIAL THE INFORMATION CONTAINED IN THIS DRAWING IS THE SOLE PROPERTY OF ULLMERS DAIRY EQUIPMENT. ANY REPRODUCTION IN PART OR AS A WHOLE WITHOUT THE WRITTEN PERMISSION OF ULLMERS DAIRY EQUIPMENT IS PROHIBITED.				UNLESS OTHERWISE SPECIFIED: DIMENSIONS ARE IN INCHES TOLERANCES: FRACTIONAL: ±1/16 ANGULAR: BEND ±0.50 TWO PLACE DECIMAL ±.030 THREE PLACE DECIMAL ±.010				TITLE: PART BREAKDOWN	
				INTERPRET GEOMETRIC TOLERANCING PER: DO NOT SCALE DRAWING		DRAWN JTK 11/4/2024	DATE 11/5/2024	SIZE B	DWG. NO. LARGE SLIDE CURD MILL PARTS LIST
LAST SAVED 11/5/2024		Q.A.		SCALE: 1:12	WEIGHT:	SHEET 2 OF 4			

4

3

2

1

B

B

A

A

4

3

2

1

LG-SLIDE-CM-HP-A0

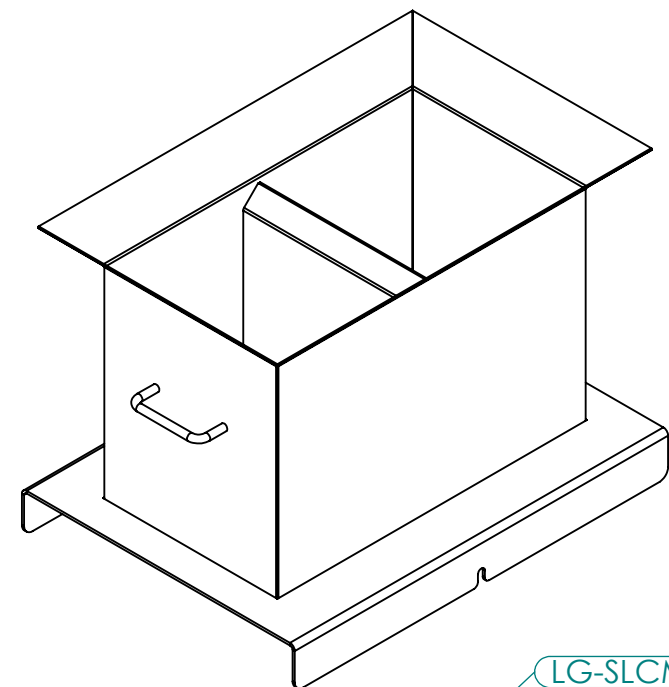

LG-SLIDE-CM-GRD-A3

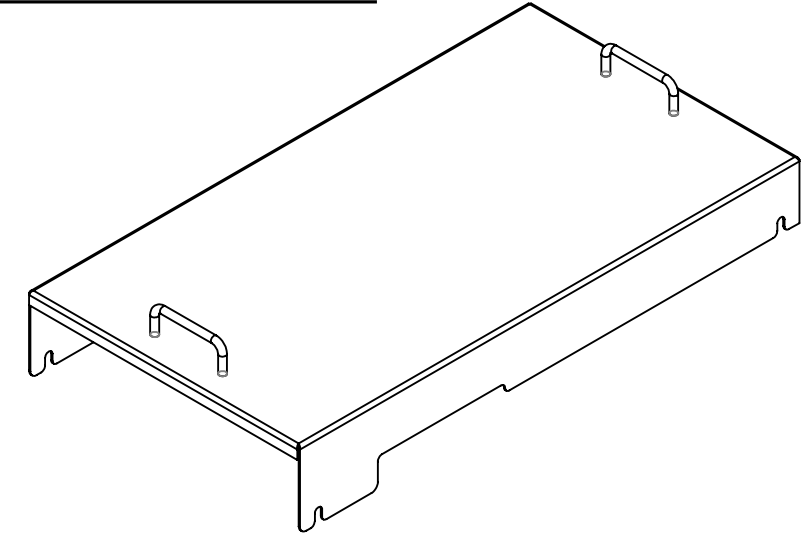

LG-SLIDE-CM-GRD-A4

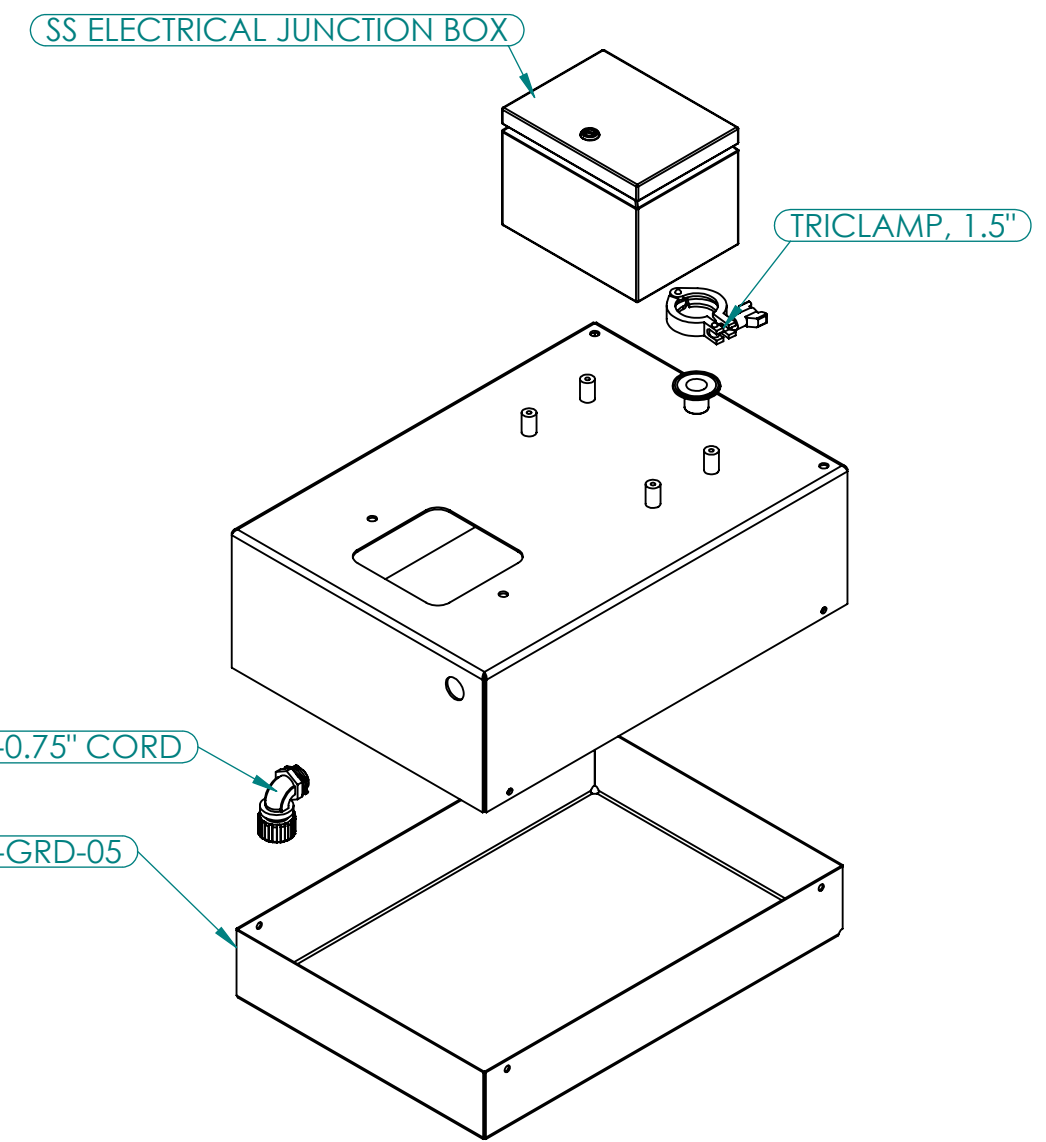

LG-SLCM-PB.625

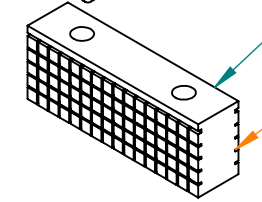

OPTIONS OF 3/8"-1" SPACING FOR BLADES

CORD CONNECTOR, 90°, 3/4" MNPT, 0.63-0.75" CORD

LG-SLIDE-CM-GRD-05

LG-SLIDE-CM-KNOB-A1

QTY 4

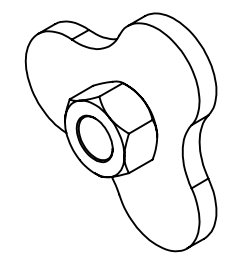

LG-SL-CM-MM-03

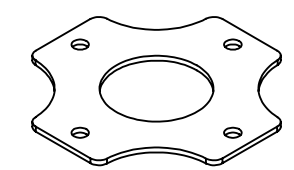

LG-SLIDE-CM-MM-A1

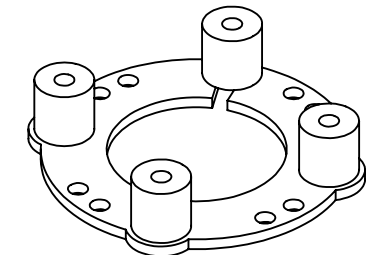

LG-SLIDE-CM-19

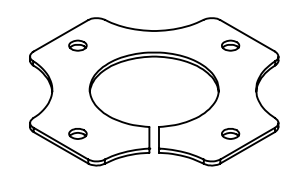

ASSEMBLIES AND PARTS ARE TYPICALLY SOLD TOGETHER, AS SHOWN
*EXCEPTIONS APPLY

QUANTITY:	PUNCH:	DIE:	MATERIAL:	Ullmer's Dairy Equipment & Fabrication						
PROPRIETARY AND CONFIDENTIAL THE INFORMATION CONTAINED IN THIS DRAWING IS THE SOLE PROPERTY OF ULLMERS DAIRY EQUIPMENT. ANY REPRODUCTION IN PART OR AS A WHOLE WITHOUT THE WRITTEN PERMISSION OF ULLMERS DAIRY EQUIPMENT IS PROHIBITED.				UNLESS OTHERWISE SPECIFIED: DIMENSIONS ARE IN INCHES TOLERANCES: FRACTIONAL: ± 1/16 ANGULAR: BEND ± 0.50 TWO PLACE DECIMAL ± .030 THREE PLACE DECIMAL ± .010		INTERPRET GEOMETRIC TOLERANCING PER: DO NOT SCALE DRAWING		TITLE: PART BREAKDOWN CONT.		
				LAST SAVED 11/5/2024		Q.A.		DRAWN JTK 11/4/2024	REVISED 11/5/2024	SIZE DWG. NO. REV
						SCALE: 1:8 WEIGHT:		SHEET 3 OF 4		

4

3

2

1

B

B

A

A

4

3

2

1

B

B

SL-CM-SHFT-01

MOTOR/ GEARBOX, 1 HP, 3PH 230/460 VAC, 25:1 RATIO, 70 RPM

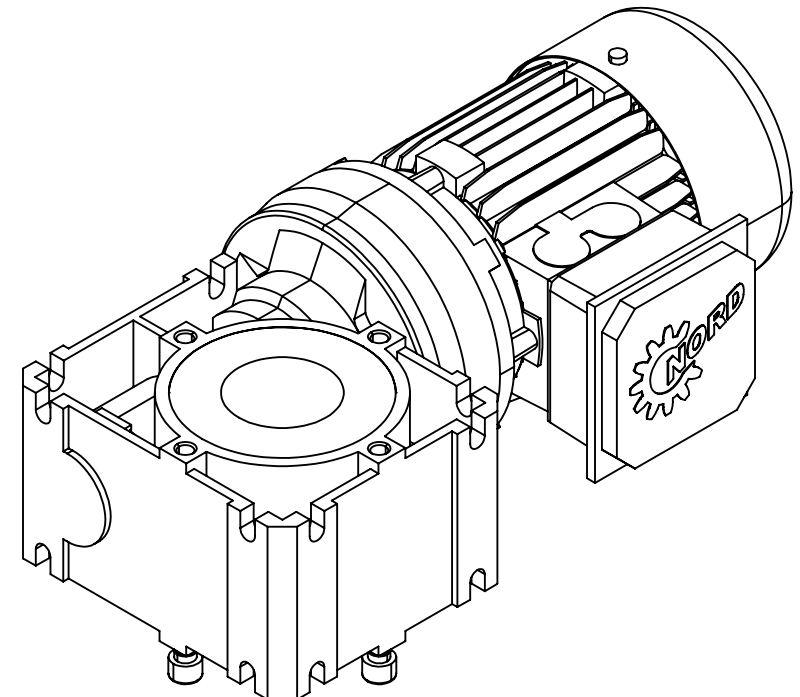
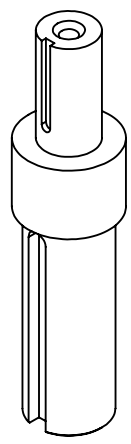

A

A

ASSEMBLIES AND PARTS ARE TYPICALLY SOLD TOGETHER,
 AS SHOWN
 *EXCEPTIONS APPLY

QUANTITY:	PUNCH:	DIE:	MATERIAL:	Ullmer's Dairy Equipment & Fabrication					
PROPRIETARY AND CONFIDENTIAL THE INFORMATION CONTAINED IN THIS DRAWING IS THE SOLE PROPERTY OF ULLMERS DAIRY EQUIPMENT. ANY REPRODUCTION IN PART OR AS A WHOLE WITHOUT THE WRITTEN PERMISSION OF ULLMERS DAIRY EQUIPMENT IS PROHIBITED.	UNLESS OTHERWISE SPECIFIED: DIMENSIONS ARE IN INCHES TOLERANCES: FRACTIONAL: ± 1/16 ANGULAR: BEND ± 0.50 TWO PLACE DECIMAL ± .030 THREE PLACE DECIMAL ± .010		INTERPRET GEOMETRIC TOLERANCING PER: DO NOT SCALE DRAWING		NAME	DATE	TITLE:		
				DRAWN	JTK	11/4/2024	PART BREAKDOWN CONT. 2		
				REVISED		11/5/2024	SIZE	DWG. NO.	REV
				ENG APPR.			B	LARGE SLIDE CURD MILL	
	LAST SAVED	11/5/2024	Q.A.				SCALE: 1:2	WEIGHT:	SHEET 4 OF 4

4

3

2

1