

4

3

2

1

PART NUMBER	DESCRIPTION	QTY
SL-CM-A1	SMALL SLIDE CURD MILL FRAME	1
SL-CM-01	SMALL SLIDE MILL- PLASTIC SLIDES	2
SL-CM-CT-A0	SMALL SLIDE CUTTER CARRIAGE	1
SL-CM-GRD-01	SLIDE CURDMILL. GUARD 1	1
SL-CM-GRD-02	SLIDE CURD MILL GUARD 2	1
SL-CM-CT-A1	ROTATING LINKAGE SUB-ASSEMBLY	1
SL-CM-CT-A2	LINKAGE SUB-ASSEMBLY	1
SL-CM-HP-A0	HOPPER ASSEMBLY	1
SL-CM-GRD-A2	LINKAGE COVER SUB-ASSEMBLY	1
SL-CM-GRD-A3	MOTOR COVER, SUB-ASSEMBLY	1
SL-CM-MM-A1	MOTOR STANDOFF SUB-ASSEMBLY	1
SL-CM-KNOB-A1	COVER KNOB SUB-ASSEMBLY	4
SL-CM-MM-03	MOTOR GASKET	1
SL-CM-MM-04	MOTOR GASKET CLAMP PLATE	1
SL-CM-SHFT-01	MOTOR SHAFT	1
92141A031	FLAT WASHER, 3/8"	6
92146A031	LOCK WASHER, 3/8"	6
92240A624	HEX BOLT 3/8"-16 X 1"	6
92141A033	FLAT WASHER, 1/2"	4
92146A033	LOCK WASHER, 1/2"	4
92240A716	HEX BOLT, 1/2"-13 X 1.375"	4
8558K3	SS THUMB KNOB, 7 LOBE, 3/8"-16	4
3746K22	FLANGED BUSHING, 5/8" SHAFT, 3/4" LONG	2
SK1S175VBIIFBII-N56C-80LP4TW	MOTOR/ GEARBOX, 1 HP, 3PH 230/460 VAC, 30:1 RATIO	1

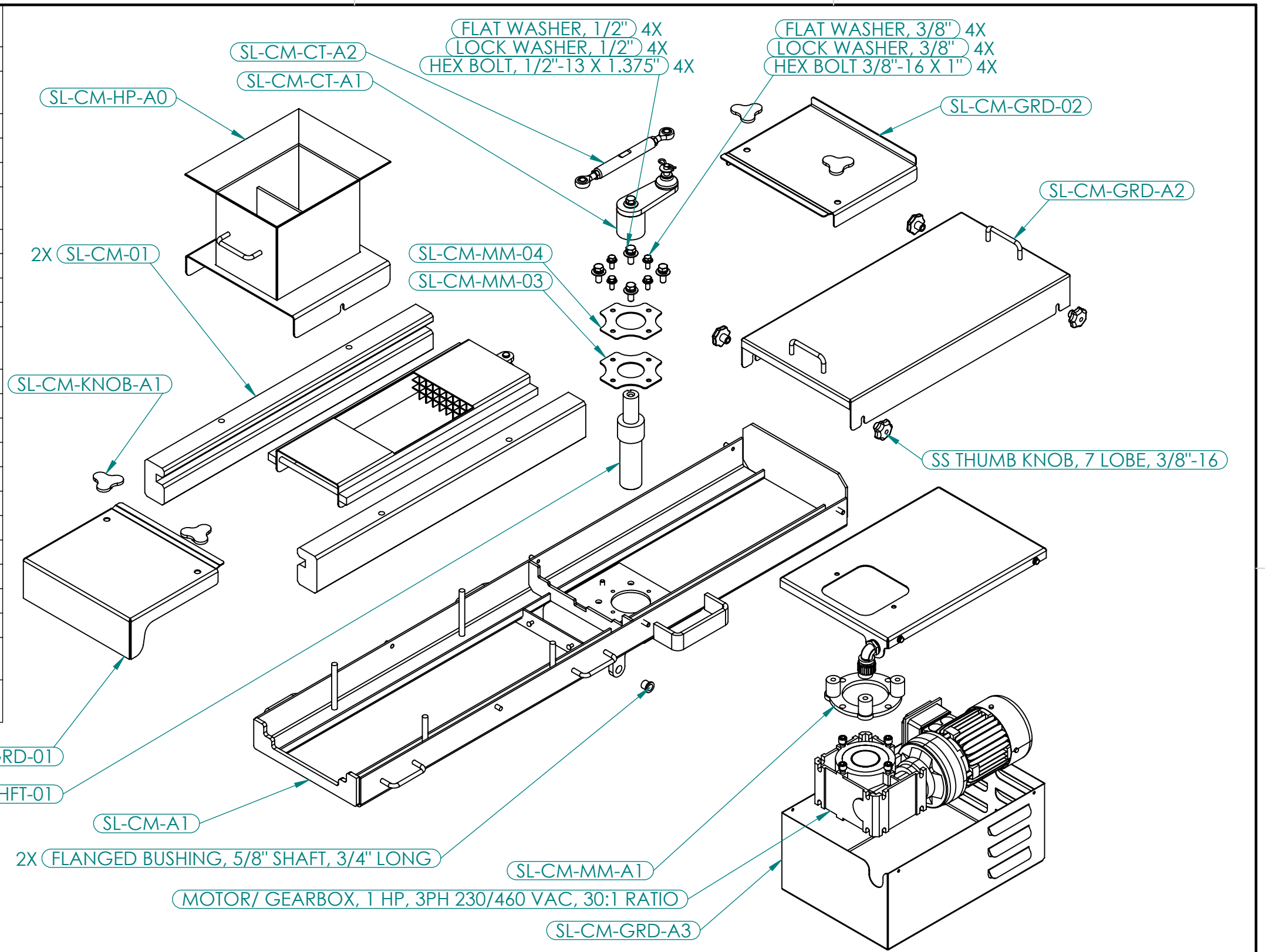

B

B

A

A

<b>QUANTITY:</b> 1	<b>PUNCH:</b>	<b>DIE:</b>	<b>MATERIAL:</b>	<b>Ullmer's Dairy Equipment &amp; Fabrication</b>			
<b>PROPRIETARY AND CONFIDENTIAL</b> THE INFORMATION CONTAINED IN THIS DRAWING IS THE SOLE PROPERTY OF ULLMERS DAIRY EQUIPMENT. ANY REPRODUCTION IN PART OR AS A WHOLE WITHOUT THE WRITTEN PERMISSION OF ULLMERS DAIRY EQUIPMENT IS PROHIBITED.				TITLE: <b>SMALL SLIDE CURD MILL- PART LIST</b>			
				DRAWN	JTK	DATE	11/5/2024
<b>UNLESS OTHERWISE SPECIFIED:</b> DIMENSIONS ARE IN INCHES TOLERANCES: FRACTIONAL: ± 1/16 ANGULAR: BEND ± 0.50 TWO PLACE DECIMAL ± .030 THREE PLACE DECIMAL ± .010				REVISED		11/6/2024	SCALE: 1:10
				ENG APPR.			
INTERPRET GEOMETRIC TOLERANCING PER: DO NOT SCALE DRAWING				MFG APPR.			SHEET 1 OF 4
LAST SAVED: 11/6/2024				Q.A.			

REVISIONS				
ZONE	REV.	DESCRIPTION	DATE	APPROVED

4

3

2

1

4

3

2

1

SL-CM-A1

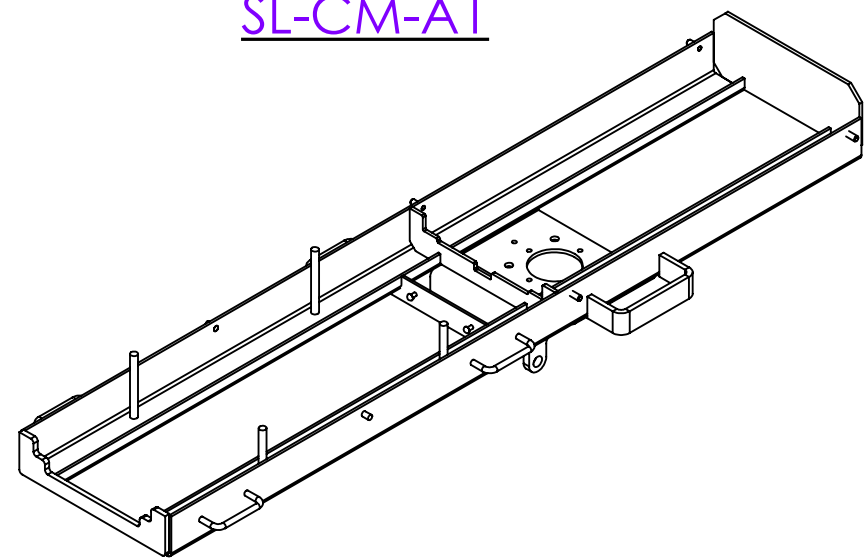

SL-CM-01  
QTY 2

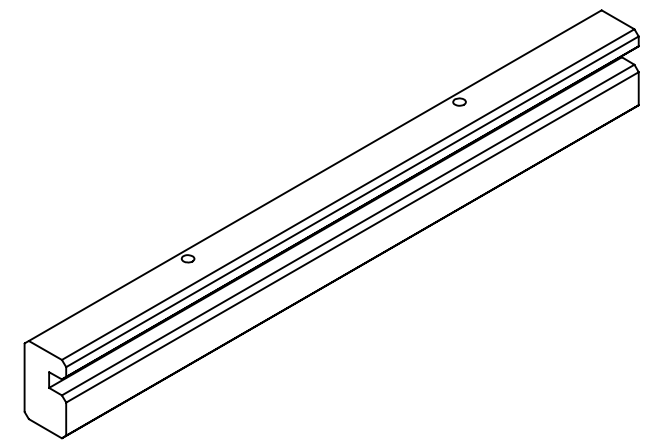

SL-CM-CT-A0

OPTIONS OF 3/8"-1" SPACING ON BLADES

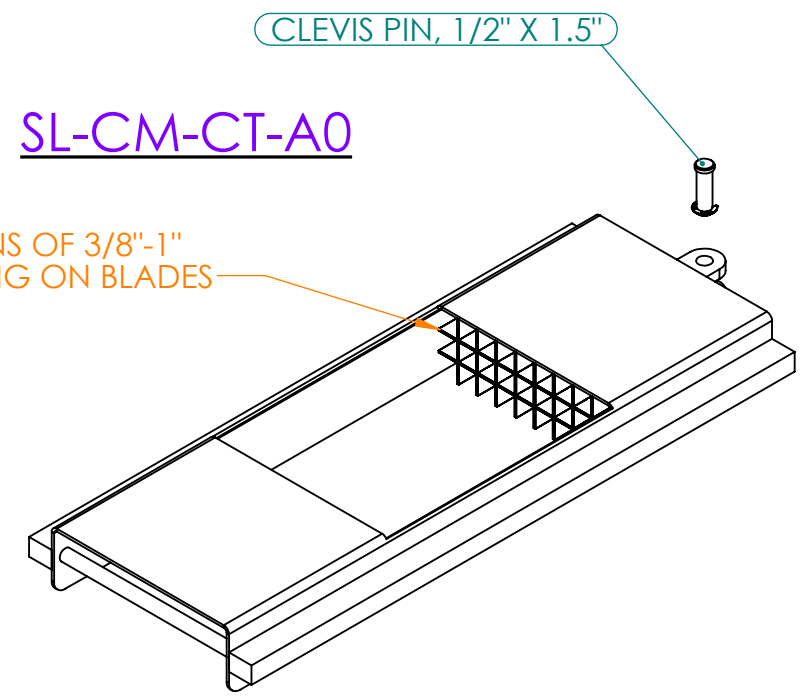

SL-CM-GRD-01

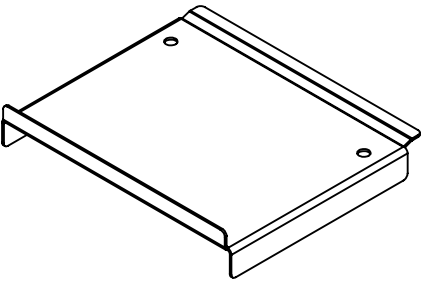
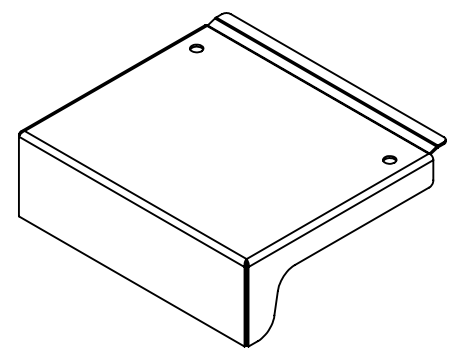

SL-CM-GRD-02

R-CLIP, 1/8" WIRE DIA X 3/8" EYE DIA

FLAT WASHER, 1/2"

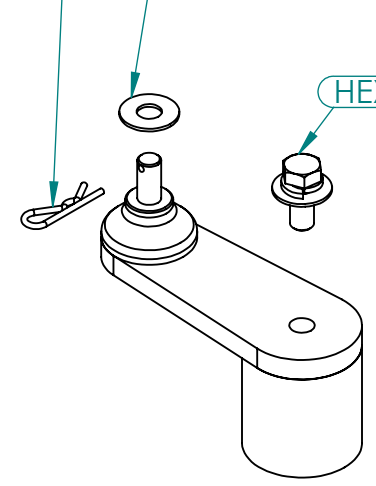

SL-CM-CT-A1

FLAT WASHER, 1/2"

LOCK WASHER, 1/2"

HEX BOLT, 1/2"-13 X 1-1/4" LONG

BALL JOINT ROD END, 1/2"-20, LH THREAD

HEX JAM NUT, 1/2"-20, LH THREAD

SL-CM-CT-11

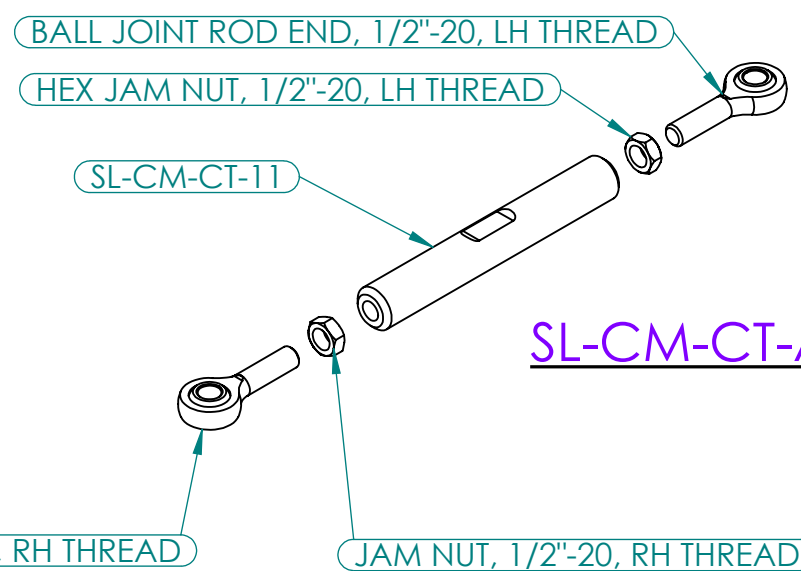

SL-CM-CT-A2

BALL JOINT ROD END, 1/2"-20, RH THREAD

JAM NUT, 1/2"-20, RH THREAD

ASSEMBLIES AND PARTS ARE TYPICALLY SOLD TOGETHER, AS SHOWN  
\*EXCEPTIONS APPLY

<b>QUANTITY:</b>	<b>PUNCH:</b>	<b>DIE:</b>	<b>MATERIAL:</b>	<b>Ullmer's Dairy Equipment &amp; Fabrication</b>								
<b>PROPRIETARY AND CONFIDENTIAL</b> THE INFORMATION CONTAINED IN THIS DRAWING IS THE SOLE PROPERTY OF ULLMERS DAIRY EQUIPMENT. ANY REPRODUCTION IN PART OR AS A WHOLE WITHOUT THE WRITTEN PERMISSION OF ULLMERS DAIRY EQUIPMENT IS PROHIBITED.				<b>UNLESS OTHERWISE SPECIFIED:</b> DIMENSIONS ARE IN INCHES TOLERANCES: FRACTIONAL: ±1/16 ANGULAR: BEND ±0.50 TWO PLACE DECIMAL ±.030 THREE PLACE DECIMAL ±.010				DRAWN	JTK	11/5/2024	TITLE: <b>PART BREAKDOWN</b>	
								REVISED		11/6/2024		
				INTERPRET GEOMETRIC TOLERANCING PER:	MFG APPR.				<b>B</b>	SMALL SLIDE CURD MILL- PART LIST		
				LAST SAVED	11/6/2024	DO NOT SCALE DRAWING	Q.A.		SCALE: 1:12	WEIGHT:	SHEET 2 OF 4	

4

3

2

1

B

B

A

A

4

3

2

1

SL-CM-HP-A0

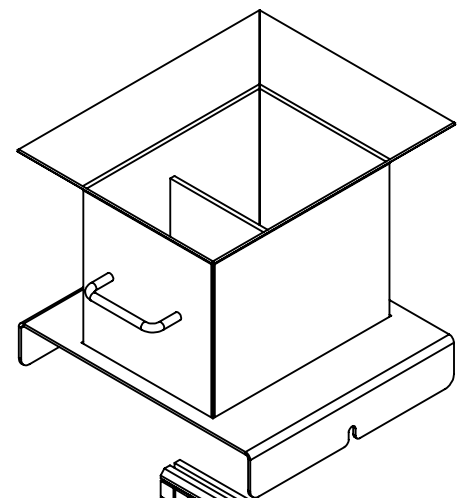

OPTIONS OF 3/8"-1" SPACING ON BLADES

SL-CM-HP-08-.75

SL-CM-GRD-A2

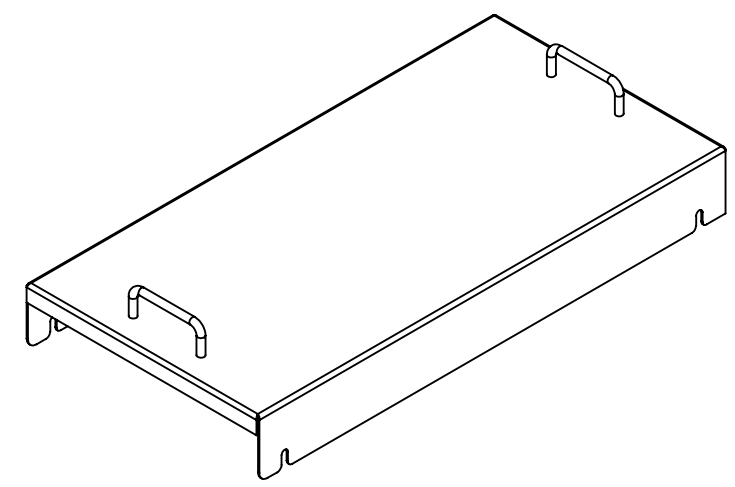

CORD CONNECTOR, 90°, 3/4" MNPT, 0.63-0.75" CORD

SL-CM-GRD-A3

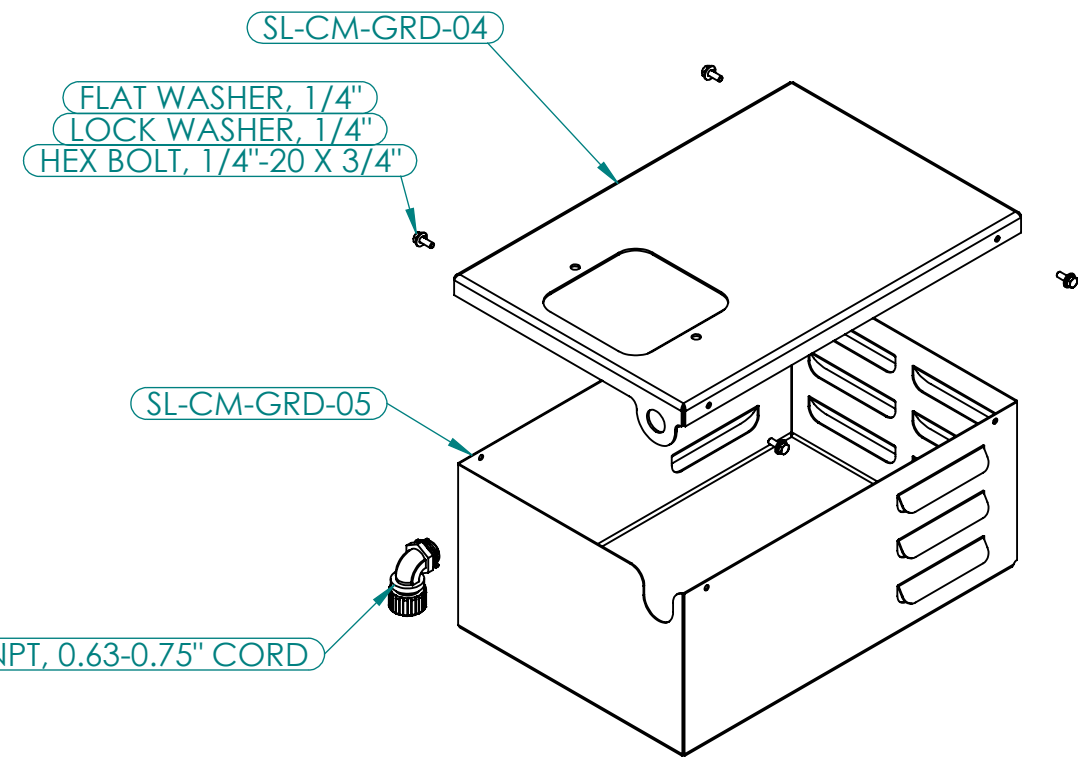

SL-CM-MM-A1

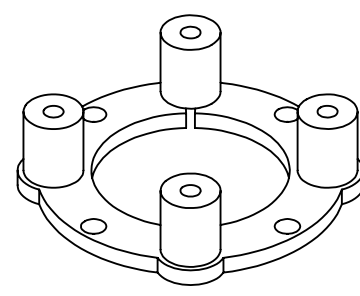

SL-CM-KNOB-A1

QTY 4

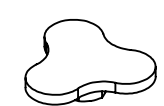

SL-CM-MM-03

WHITE BUNA-N

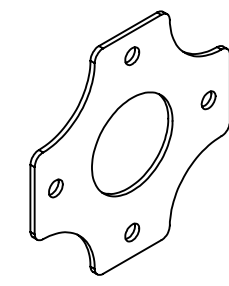

SL-CM-MM-04

304 SS

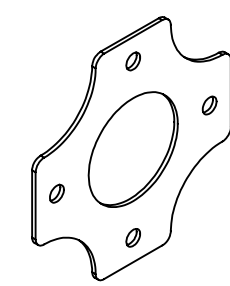

ASSEMBLIES AND PARTS ARE TYPICALLY SOLD TOGETHER, AS SHOWN  
\*EXCEPTIONS APPLY

<b>QUANTITY:</b>	<b>PUNCH:</b>	<b>DIE:</b>	<b>MATERIAL:</b>	<b>Ullmer's Dairy Equipment &amp; Fabrication</b>					
<b>PROPRIETARY AND CONFIDENTIAL</b> THE INFORMATION CONTAINED IN THIS DRAWING IS THE SOLE PROPERTY OF ULLMERS DAIRY EQUIPMENT. ANY REPRODUCTION IN PART OR AS A WHOLE WITHOUT THE WRITTEN PERMISSION OF ULLMERS DAIRY EQUIPMENT IS PROHIBITED.		<b>UNLESS OTHERWISE SPECIFIED:</b> DIMENSIONS ARE IN INCHES TOLERANCES: FRACTIONAL: ±1/16 ANGULAR: BEND ±0.50 TWO PLACE DECIMAL ±.030 THREE PLACE DECIMAL ±.010		DRAWN: JTK REVISED: ENG APPR.: MFG APPR.: Q.A.:		DATE: 11/5/2024 11/6/2024		TITLE: PART BREAKDOWN CONT.	
LAST SAVED		11/6/2024		DO NOT SCALE DRAWING		SCALE: 1:8		WEIGHT: SHEET 3 OF 4	

4

3

2

1

B

B

A

A

4

3

2

1

B

B

SL-CM-SHFT-01

MOTOR/ GEARBOX, 1 HP, 3PH 230/460 VAC, 30:1 RATIO

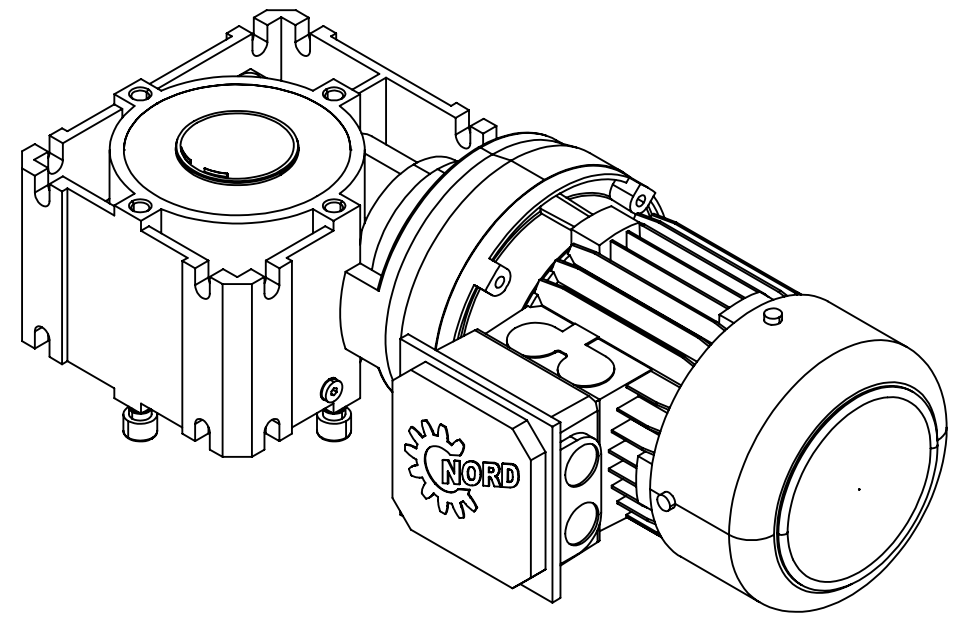
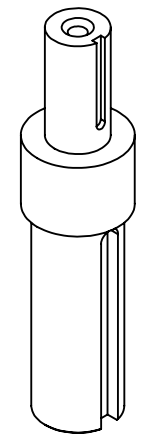

A

A

ASSEMBLIES AND PARTS ARE TYPICALLY SOLD TOGETHER,  
AS SHOWN  
\*EXCEPTIONS APPLY

<b>QUANTITY:</b>	<b>PUNCH:</b>	<b>DIE:</b>	<b>MATERIAL:</b>	<b>Ullmer's Dairy Equipment &amp; Fabrication</b>					
<b>PROPRIETARY AND CONFIDENTIAL</b> THE INFORMATION CONTAINED IN THIS DRAWING IS THE SOLE PROPERTY OF ULLMERS DAIRY EQUIPMENT. ANY REPRODUCTION IN PART OR AS A WHOLE WITHOUT THE WRITTEN PERMISSION OF ULLMERS DAIRY EQUIPMENT IS PROHIBITED.	<b>UNLESS OTHERWISE SPECIFIED:</b> DIMENSIONS ARE IN INCHES TOLERANCES: FRACTIONAL: ± 1/16 ANGULAR: BEND ± 0.50 TWO PLACE DECIMAL ± .030 THREE PLACE DECIMAL ± .010		INTERPRET GEOMETRIC TOLERANCING PER: DO NOT SCALE DRAWING		NAME	DATE	TITLE:		
					JTK	11/5/2024	PART BREAKDOWN CONT. 2		
						11/6/2024	SIZE	DWG. NO.	REV
							<b>B</b>	SMALL SLIDE CURD MILL- PART LIST	
	LAST SAVED	11/6/2024	Q.A.	SCALE: 1:2	WEIGHT:	SHEET 4 OF 4			

4

3

2

1